



# CHAPEL COTTAGE

---

GLENRIDDING - THE LAKE DISTRICT



CHAPEL COTTAGE - GLENRIDDING



# CHAPEL COTTAGE

GLENRIDDING - THE LAKE DISTRICT

A truly charming family home close to the shores of Ullswater in the very heart of the English Lake District.

Constructed in traditional stone and Lakeland slate, Chapel Cottage has been sensitively and considerably renovated throughout.

A delightful residence which will be equally suited to both those seeking a permanent base here in the National Park, or as a boutique holiday retreat or a second home.

 Four bedrooms

 Three bathrooms

Built in approximately 1903, Chapel Cottage was originally the Sunday School for the adjacent Wesleyan chapel - itself is now a family home - and, arriving at the property, one will find much of the original character has been retained.

The new Accoya wooden external doors and windows are both elegant and hard-wearing and are of bespoke manufacture by Marthwaite Joinery to suit the local vernacular and finished in Farrow & Ball Downpipe Grey, a colour familiar to properties in the region.

Step through the welcoming porch and find yourself in a warming home filled with fine attention to detail, choice of quality materials and considered design that achieves the best from this unique building.

The beautiful central hallway with engineered oak flooring and heritage colour palette draws your attention to the full height windows to the rear and onto the living wall outside.

The internal doors are all solid oak, with deep pitched skirting, profiled architraves and thoughtful use of tongue and groove panelling all combining to reassuringly retain the authenticity of the property.

Adjacent is the spacious dual-aspect living room, the glazed double doors from the hallway allowing more of that lovely Lakeland light to bathe the space.



The oak flooring continues seamlessly through where it meets the robust feature sandstone fireplace with its slate hearth and cozy wood-burning stove – the ideal spot to unwind after exploring the fells and foothills around Ullswater and valleys nearby.

The front-facing aspect of the living room enjoys the morning sun whilst, later in the day, the deep window seat at the rear is definitely the place to while away a few tranquil moments.

The bespoke solid walnut kitchen by English Hardwood Design boasts Miele appliances, granite worktops, and a central island, with underfloor heating beneath the natural limestone flags adding extra comfort.

It's quite perfect for both casual meals and entertaining, with plenty of space for a large dining table.

The ground floor also includes a practical boot room, separate laundry, and a shower room.



As mentioned, Chapel Cottage was the Sunday School for Glenridding village, which some of the locals remember attending as children.

Originally one single space, open from ground floor to the rafters, the open feel has been retained throughout the home, with each room refreshingly light and spacious.

This includes the first floor bedrooms: tri-fold doors with their Juliette balconies are a beautiful feature of the two front-facing rooms from where Place Fell and Ullswater provide an ever-changing vista.

To the rear, the bedroom windows are an innovative combination of floor level and expansive roof lights, the latter framing the terraced garden and fellside cottages beyond.

Each bedroom extends into the roof space, affording more height for that generous light. Against pristine white walls the original solid roof timbers are exposed, a reassuring reminder of the building's steadfast construction.

Chapel Cottage has two bathrooms on the first floor with both master ensuite and family bathroom feeling quite luxurious thanks to floor to ceiling porcelain tiling, underfloor heating, and Villeroy & Boch baths for contemplative relaxation.



There are well established gardens to the front and back of Chapel Cottage, along with generous parking for two cars and plenty of turning space.

A path leads through the terraced garden at the rear with raised beds, mature shrubs and trees.

Here you'll also find a seating area with its own fire pit, all constructed in Honister slate. Elevated and private, it's a great place to spend an evening nestled beneath the boughs of the trees and bushes behind.

Chapel Cottage was fully re-roofed in 2014 and offers the perfect blend of local heritage, traditional craftsmanship and modern luxury and conveniences.

The picture postcard perfect Glenridding on the southern shores of Ullswater is a quintessential Lakeland village. There are wonderful views to be discovered at every turn and the village is well serviced by local shops and hostelrys.

Travelling by car from the South (Windermere and Ambleside), the journey to Glenridding takes one over Kirkstone Pass past the imposing Red Screes before the descent to Brotherswater and Patterdale.

From the North, the road hugs the shore along the length of Ullswater from Pooley Bridge and through Watermillock, passing Aira Force waterfalls along the way.



GROUND FLOOR

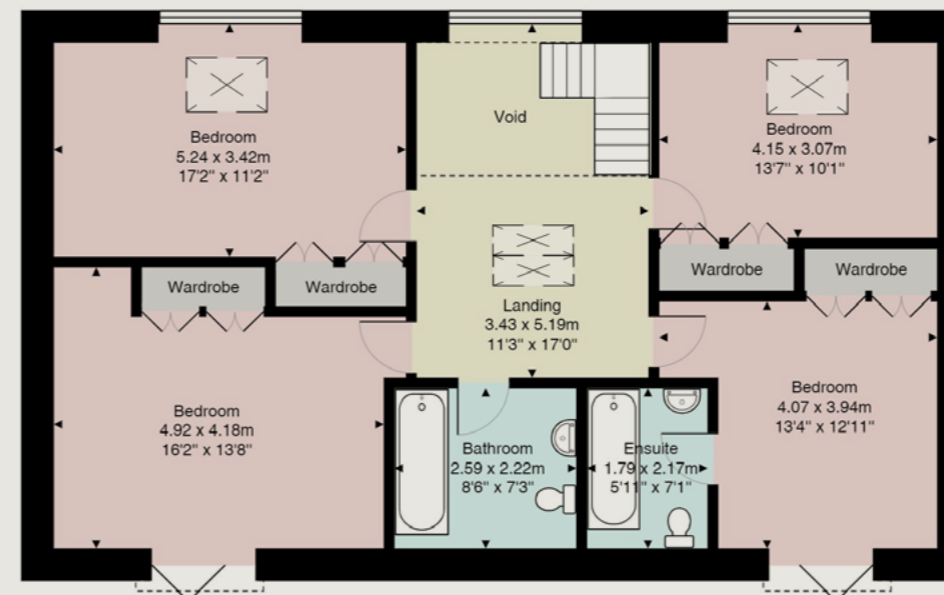

FIRST FLOOR

Approximate Total Area: 210m<sup>2</sup> / 2,261 ft<sup>2</sup>  
 This plan is for illustrative purposes only and should be used as such by any prospective purchasers. The appliances and systems shown have not been tested and no guarantee to their operability or efficiency can be given. Measurements are approximate and for display purposes only.

Energy Efficiency Rating		Current	Potential
Very energy efficient - lower running costs			
(92+)	A		
(81-91)	B		
(69-80)	C	69	76
(55-68)	D		
(39-54)	E		
(21-38)	F		
(1-20)	G		
Not energy efficient - higher running costs			
England, Scotland & Wales		EU Directive 2002/91/EC	

Services: Mains Water and Electric.

Oil fired central heating.

Private drainage via a BioDisc domestic sewage treatment plant. Under the General Binding Rules 2020, we ask buyers make their own investigations regarding compliance of the septic tank/private drainage and take advice from their mortgage lender or legal advisors.

Tenure: Freehold

Council Tax Band: G

To check Broadband and Mobile phone coverage, see our Key Facts for Buyers report or visit: [www.ofcom.org.uk/phones-telecoms-and-internet/coverage](http://www.ofcom.org.uk/phones-telecoms-and-internet/coverage)



# CHAPEL COTTAGE

GLENRIDDING - THE LAKE DISTRICT

Chapel Cottage  
Glenridding, Penrith  
The Lake District CA11 0PG

///decisions.concluded.enough

Ambleside	9 miles
Windermere	13 miles
Penrith	13 miles
Keswick	15 miles
Kendal	20 miles



**MILNE MOSER**  
SALES + LETTINGS

100 Highgate, Kendal, Cumbria LA9 4HE

Telephone. 01539 725 582

Email. [kendalproperty@milnemoser.co.uk](mailto:kendalproperty@milnemoser.co.uk)

[www.milnemoser.co.uk](http://www.milnemoser.co.uk)



These particulars are set out as a general outline in accordance with the Consumer Protection from Unfair Trading Regulations 2008 only for the guidance of intending purchasers or lessees, and do not constitute any part of an offer or contract. Details are given without any responsibility, and any intending purchasers, lessees or third parties should not rely on them as statements or representations of fact, but must satisfy themselves by inspection or otherwise as to the correctness of each of them. We have not carried out a structural survey and the services, appliances and specific fittings have not been tested. All photographs, measurements, floor plans and distances referred to are given as a guide only and should not be relied upon for the purchase of carpets or any other fixtures or fittings. Gardens, roof terraces, balconies and communal gardens as well as tenure and lease details cannot have their accuracy guaranteed for intending purchasers. Lease details, service ground rent (where applicable) are given as a guide only and should be checked and confirmed by your solicitor prior to exchange of contracts. No person in the employment of Milne Moser has any authority to make any representation or warranty whatever in relation to this property. Purchase prices, rents or other prices quoted are correct at the date of publication and, unless otherwise stated, exclusive of VAT. Intending purchasers and lessees must satisfy themselves independently as to the incidence of VAT in respect of any transaction relating to this property. The information provided by the vendor in these particulars is based on the opinion of the vendor only and any intending purchaser, lessee or third party should not rely upon this information as a statement or representation of fact but must satisfy themselves by inspection or otherwise as to the correctness of the information provided.